



HID-Basic ballasts for HPL and HPI(PLUS) lamps

BHL 400L 204

The HID-Basic ballast is an impregnated (HID standard) electromagnetic ballast for HID lamps, for use in combination with an external ignitor.

Product data

General information		Temperature	
Application code	L204	T-winding (max.)	130 °C
		Delta-T normal conditions	70 °C
Operating and electrical		Approval and application	
Input Voltage	240 V	Approval marks	CE marking
Input frequency	50 Hz		
Power factor 100% load (min.)	0.85	Product data	
Mains voltage performance (AC)	-8% - +6%	Full product code	871016303212200
Mains voltage safety (AC)	-10% - +10%	Order product name	BHL 400L 204
Input current with PF correction	2.15 A	EAN/UPC – product	8710163148267
Input current without PF Correction	3.25 A	Order code	913710101350
Power factor without PF compensation (nom.)	0.60	SAP numerator – quantity per pack	1
Power losses (nom.)	23 W	Numerator – packs per outer box	6
		SAP material	913710101350
Wiring		Copy Net Weight (Piece)	2.833 kg
Connector type	Screw		
System characteristics			
Rated ballast-lamp power	400 W		

HID-Basic ballasts for HPL and HPI(PLUS) lamps

Dimensional drawing

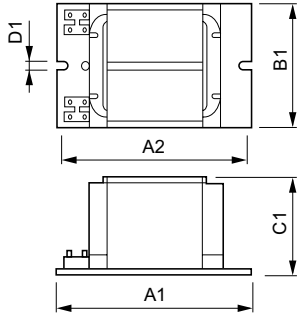

Product	D1	C1	A1	A2	B1
BHL 400L 204	6.2 mm	64.5 mm	150.0 mm	135.0 mm	75.5 mm

BHL 400L 204

