



SmartBright LED Floodlight

BVP174 LED95/WW 100W WB GREY SAA KC

LED module 6600 lm

The SmartBright LED Floodlight is a versatile floodlight engineered to deliver significant energy savings, an ideal solution for diverse floodlighting applications. The product is also designed to meet relevant performance and safety standards, offering you reliable and long-lasting performance.

Product data

General Information	
Lamp family code	LED66 [LED module 6600 lm]
Lamp colour code	730 warm white
Light source replaceable	No
Driver included	Yes
Optical cover/lens type	PC-UV [Polycarbonate bowl/cover UV-resistant]
Luminaire light beam spread	30° x 80°
Control interface	-
Connection	Flying leads/wires
Cable	Cord 0.6 m without plug
Protection class IEC	Safety class I (I)
Flammability mark	F [For mounting on normally flammable surfaces]
CE mark	CE mark
Constant light output	No
Number of products on MCB (16 A type B)	26

Light source engine type	LED
Operating and Electrical	
Input Voltage	220 to 240 V
Input frequency	50 or 60 Hz
Inrush current	9.7 A
Inrush time	0.065 ms
Power factor (min.)	0.9

Controls and Dimming	
Dimmable	No

Mechanical and Housing	
Housing material	Aluminum die-cast
Optical cover/lens material	Polycarbonate
Mounting device	MBA [Mounting bracket adjustable]
Optical cover/lens shape	Flat
Optical cover/lens finish	Frosted

SmartBright LED Floodlight

Overall length	356 mm
Overall width	190 mm
Overall height	53 mm
Effective projected area	0.056 m ²
Colour	Grey

Approval and Application

Ingress protection code	IP65 [Dust penetration-protected, jet-proof]
Mech. impact protection code	IK07 [2 J reinforced]

Initial Performance (IEC Compliant)

Initial luminous flux	9500 lm
Luminous flux tolerance	+/-10%
Initial LED luminaire efficacy	95 lm/W
Lamp colour temperature	3000 K
Colour Rendering Index	>70
Initial chromaticity	SDCM<7
Initial input power	100 W

Power consumption tolerance	+/-10%
-----------------------------	--------

Application Conditions

Ambient temperature range	-40 to +45 °C
Maximum dimming level	Not applicable

Product Data

Full product code	871016332102899
Order product name	BVP174 LED95/WW 100W WB GREY SAA KC
EAN/UPC – product	8710163321028
Order code	911401690804
SAP numerator – quantity per pack	1
Numerator – packs per outer box	6
SAP material	911401690804
SAP net weight (piece)	3.000 kg



Dimensional drawing

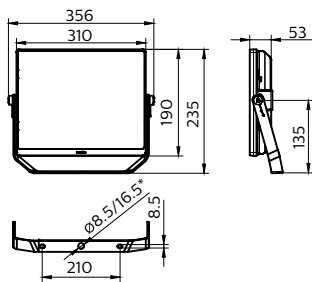

* Configuration for Australia, New Zealand and Korea

BVP173/174/175/176 Smartbright

